

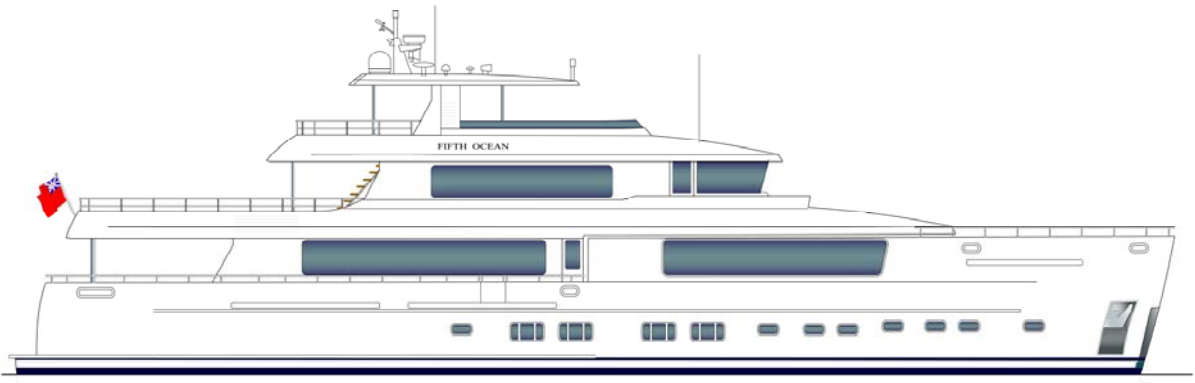

# FIFTH OCEAN YACHTS®

WE CRAFT THE FINEST STEEL AND ALUMINUM CUSTOM YACHTS  
TO DELIVER TAILOR MADE DREAMS TO OUR OWNERS



**GINTON**  
NAVAL ARCHITECTS BY

0 5 10 15 20 25 30 35 40 45 50 55 60 65 70 PROFILE

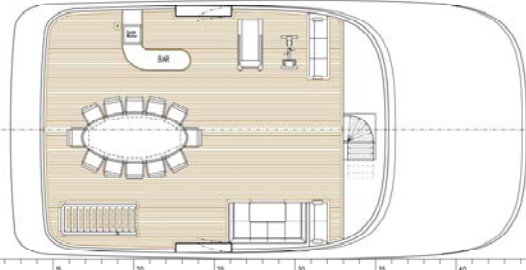

0 5 10 15 20 25 30 35 40 45 50 55 60 65 70 FLY BRIDGE DECK

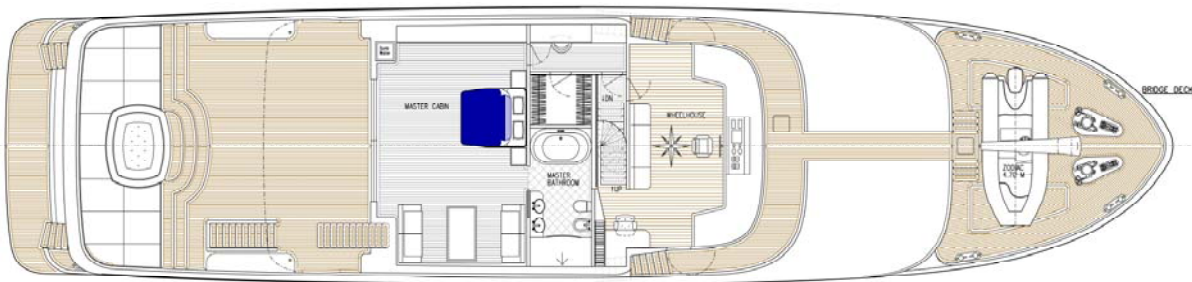

0 5 10 15 20 25 30 35 40 45 50 55 60 65 70 BRIDGE DECK

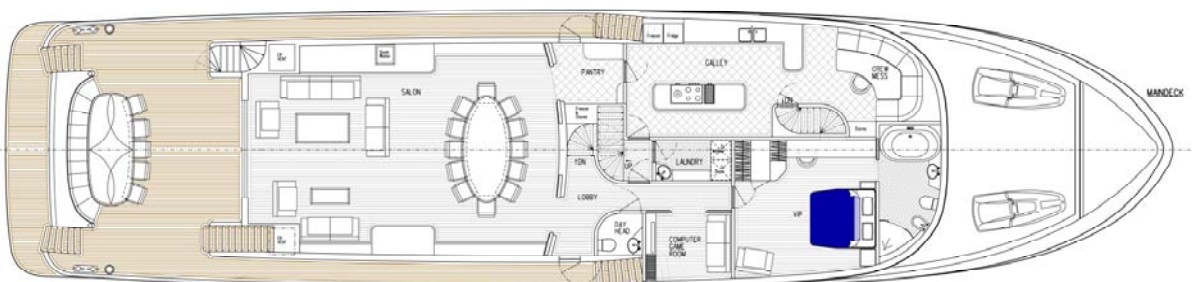

0 5 10 15 20 25 30 35 40 45 50 55 60 65 70 MAIN DECK

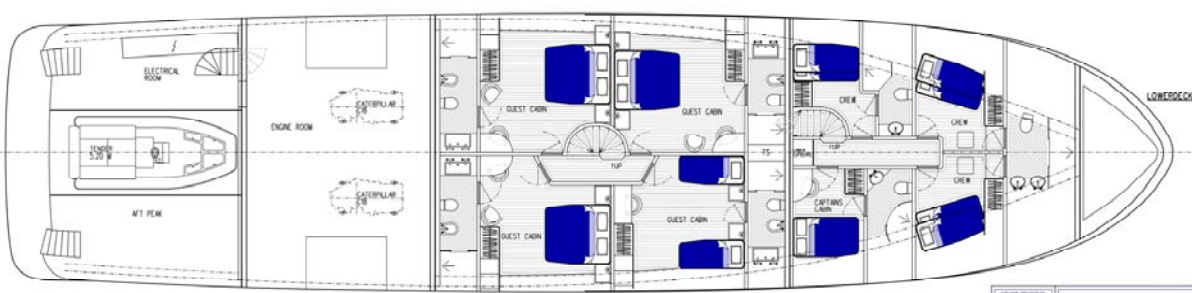

0 5 10 15 20 25 30 35 40 45 50 55 60 65 70 LOWER DECK

**GINTON**  
NAVAL ARCHITECTS BY

35.5 m, MY	
Name: Fifth Ocean	Type: KX00
General Arrangement	
Drawn: J.B.	Date: Aug 2011
Scale: 1:50	Sheet: 154-130

Revision	Description
P1 21-11-2011	OWNER'S MEETINGS, MAIN DECK, PROFILE, FOREDECK AND SIMPLIFICATION UPDATE
P2 14-10-2011	UPGRADE ENGINE ROOM LEVELS
P1 28-10-2011	ACCOMMODATION BRIDGEDECK

DEFINITIVE



**FIFTH OCEAN YACHTS®**

WE CRAFT THE FINEST STEEL AND ALUMINUM CUSTOM YACHTS  
TO DELIVER TAILOR MADE DREAMS TO OUR OWNERS

DESCRIPTION:

OCEAN GOING, ROUND BILGE, BULBOUS BOW, DISPLACEMENT MOTOR YACHT.

CONSTRUCTION OF HULL: STEEL.

CONSTRUCTION OF SUPERSTRUCTURE/ DECKHOUSE: ALUMINIUM.

LENGTH OVER ALL	35.70	[M]
LENGTH WATERLINE (FULL LOAD)	34.32	[M]
BEAM MOULDED	8.60	[M]
BEAM OVER ALL	8.90	[M]
DRAFT (FULL LOAD)	2.50	[M] APPROX.
SPEED (SEA TRIAL LOAD)	14.0	[M]
FUEL CAPACITY TOTAL	45.0	[M <sup>3</sup> ]
FRESH WATER CAPACITY	14.0	[M <sup>3</sup> ]
SEWAGE	13.0	[M <sup>3</sup> ]
RANGE AT 14.0 KNOTS INCLUDED	1837	[NM] 25% MARGIN
RANGE AT 12.0 KNOTS INCLUDED	2566	[NM] 25% MARGIN
RANGE AT 10.0 KNOTS INCLUDED	3880	[NM] 25% MARGIN
MAIN ENGINE AT 2100 RPM	2X CATERPILLAR C18, B RATING 500KW (680MHP)	
REDUCTION GEAR	ZF W650 3.605:1	
GENERATOR 1500 RPM	2X CATERPILLAR 4.4 50HZ 86EKW 107KV*A AT	

REGISTRATION

THE YACHT WILL BE REGISTERED UNDER CAYMAN ISLANDS.

CLASSIFICATION

BUREAU VERITAS.